

Dimensions

Available Colour Temperatures:
2200K, 2700K, 3000K, 4000K, 6500K

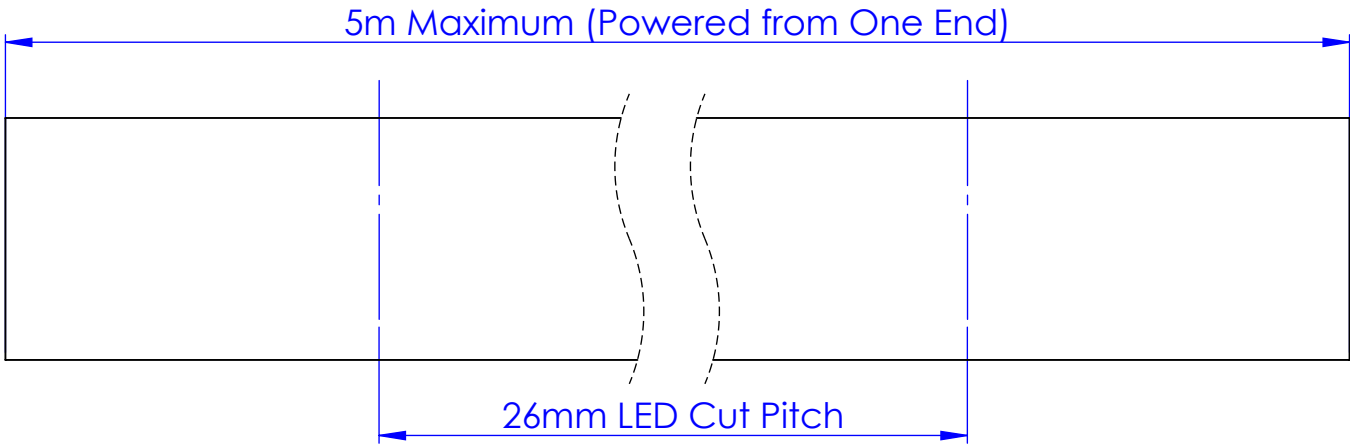

Compatible Accessories

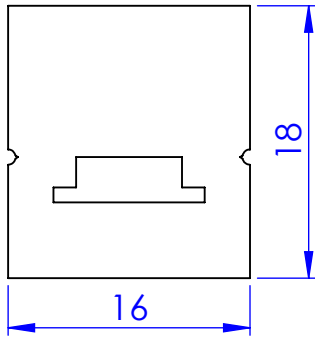
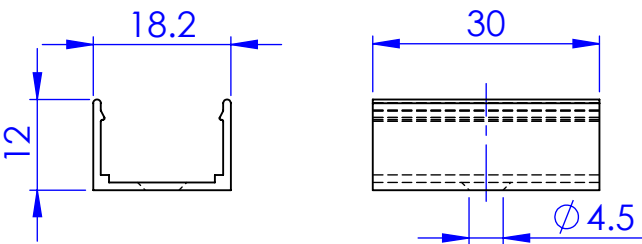

Bracket UA49219

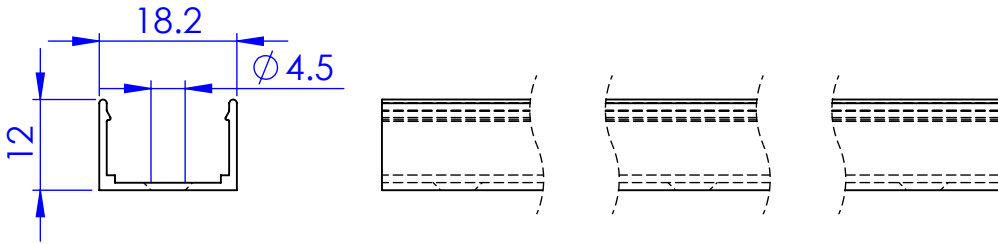

Housing UA49218

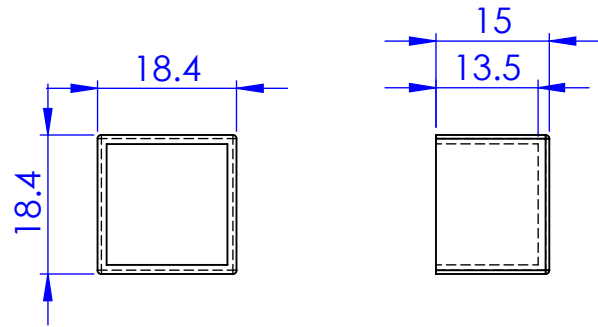

End Cap UA49221

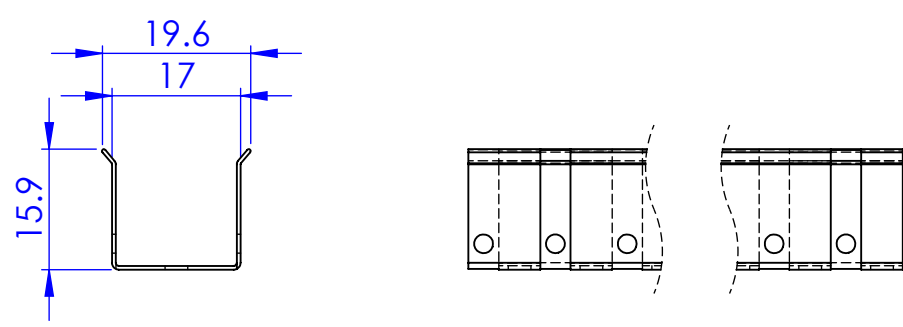

Bendable Housing UA49220

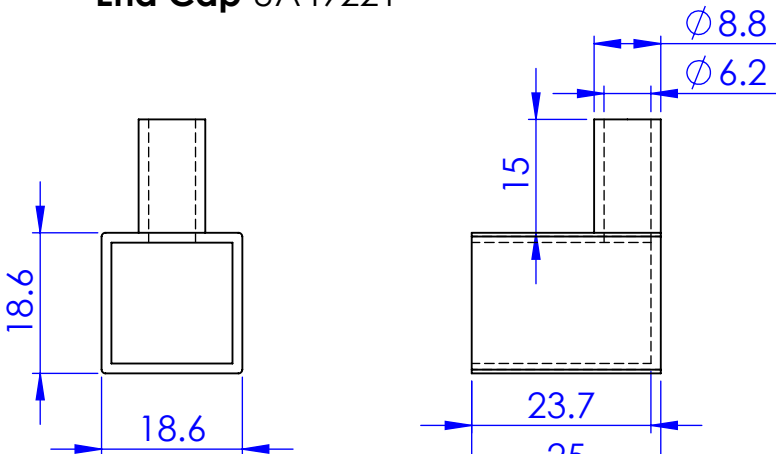

Side Cap UA49223

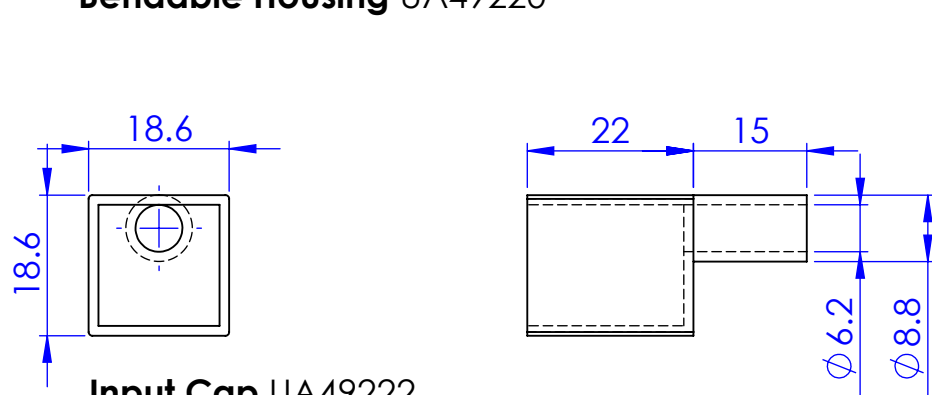

Input Cap UA49222

Bend Radii

75mm Minimum Bend Radius
(Parallel to LED Plane)

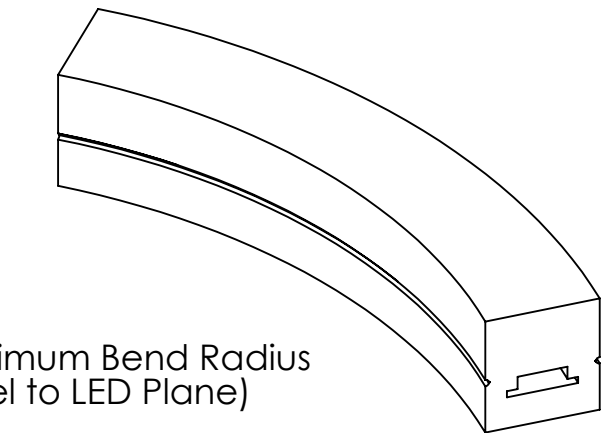

125mm Minimum Bend Radius
(Perpendicular to LED Plane)

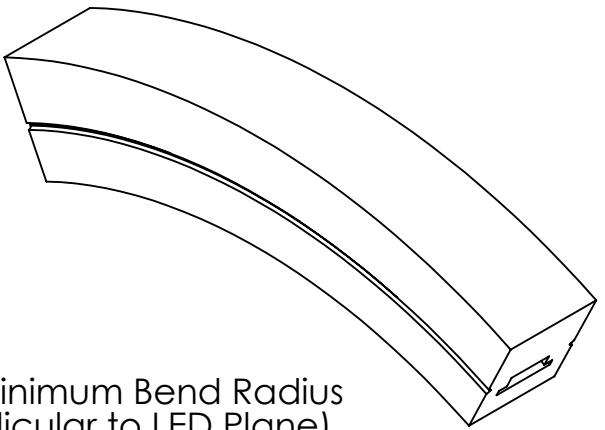

ANY QUERIES OR IF IN DOUBT PLEASE CONTACT THE DESIGNER

CUSTOMER: ENTER CUSTOMER
JOB REFERENCE: ENTER CRM#
QTY: ENTER QUANTITY

REQUIRED DATE: ENTER DATE
DELIVERY METHOD: ENTER METHOD

FINAL INSPECTION
(PRIOR TO DESPATCH)
DATE: SIGNED:

FABRIC INCLUDED?
YES: NO:
TEST FABRIC BEFORE PACKING

unibox

Greengate Industrial Estate, Greenside Way, Middleton,
Manchester, M24 1SW, UK W: www.unibox.co.uk
info@unibox.co.uk
Tel: 0845 277 6000 Fax: 0845 277 6001

Copyright © 2022. This drawing and all copies and derivative
works are the exclusive property of United Aluminium Limited.
This drawing must not be copied or disclosed in any manner to
any third party without the prior written consent of a director
of United Aluminium Limited. All rights reserved.

DRAWING TITLE:
U-NEON-1618-3D

MATERIAL:
VARIOUS

FINISH:
-

DRAWN BY: CREATED DATE:
JHD 26/09/2024

CHECKED BEFORE PUBLISHING BY:
CC

PART No:
UA49133

DRAWING No:
UA49133

REVISION:
A

SHEET No:
1 of 1

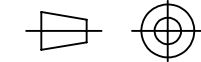

TOLERANCES:
DIMENSIONS IN MM
UNLESS OTHERWISE STATED

DIMENSIONS +/- 0.5mm
ANGLE +/- 0.5°

SHEET SIZE: SCALE:
A3 2:1